

# PFSPR

## FABRICATED SEPARATOR

### DESCRIPTION:

Moisture Separator is used to improve the quality of steam or compressed air. As steam or compressed air enters in to the separator, a series of internal baffles separate moisture from the media. Liquid droplets falls below due to gravity which needs to be drained by steam trap or Drain trap.

### AVAILABLE TYPES:

**Dish End Design**

### SIZES:

**Dish End Design:** 1", 1½", 2", 2½", 3", 4", 6"

**\*Note:** - For sizes above 2½" please contact our sales representative

### END CONNECTIONS:

**Dish End Design:** 1", 1½", 2" Screwed (NPT)  
2½", 3", 4", 6" Flanged #150, #300"

### LIMITING CONDITIONS:

FLANGE TYPES	MAX. WORKING PRESSURE	MAX WORKING TEMPERATURE
#150	284.2 at 100 °F	797 °F at 79.77 psi
#300	609.16 at 482 °F	797 °F at 417.7 psi

### INSTALLATION:

The Separator should be fitted with the Inlet & Outlet connections horizontally in line according to flow direction arrow marked on body. Drain should be pointed downwards, The steam trap or drain trap is required to be installed at drain point.

### DIMENSIONS:

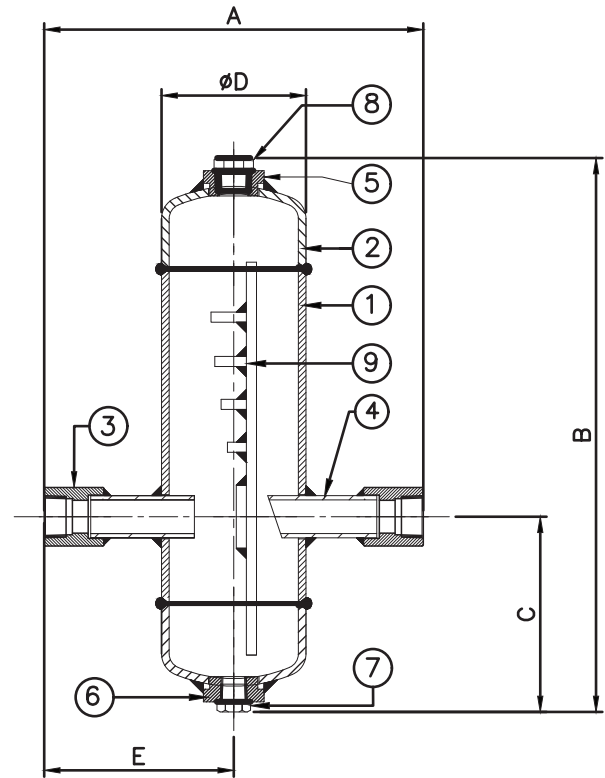

1", 1½", 2" Screwed (NPT)

Sizes	A	B	C	D	E
1"	11.8	17.3	6.1	3.9	5.9
1½"	15.4	21.3	6.5	3.9	7.7
2"	15.9	23.1	6.7	5.9	8.0
2½"	22.5	25.6	8.3	5.9	11.3

## BILL OF MATERIAL:

NO	PART	MATERIAL	QTY
1	BODY	ASTM A106 Gr. B	1
2	TOP/ BOTTOM DISH END	ASTM A516 Gr.70 / ASTM A234 Gr. WPB	2
3	INLET/ OUTLET COUPLING	ASTM A105	2
4	INLET/ OUTLET PIPE	ASTM A106 Gr. B	2
5	TOP BUSH	ASTM A105	1
6	BOTTOM BUSH	ASTM A105	1
7	DRAIN PLUG	ASTM A105	1
8	VENT PLUG	ASTM A105	1
9	BAFFLE PLATE	ASTM A516 Gr. 70	1
10	INLET/ OUTLET FLANGE	ASTM A105	2

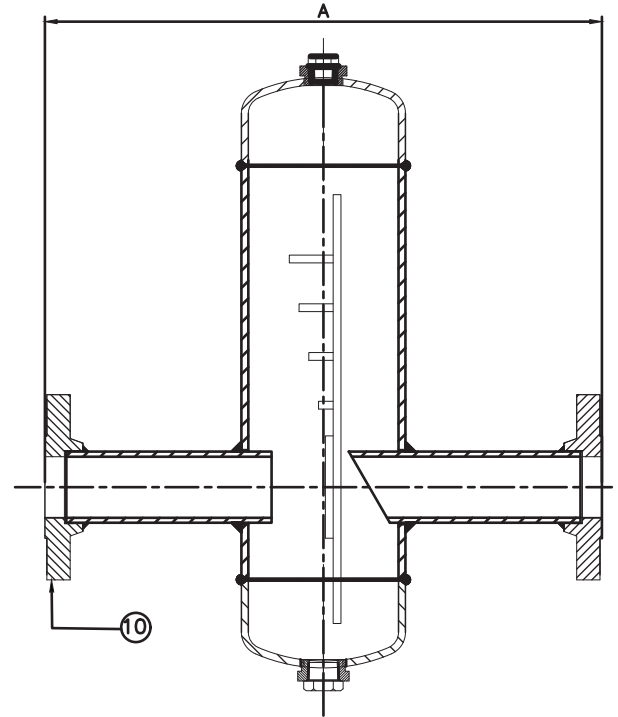

**2½", 3", 4", 6" Flanged**

**HOW TO ORDER:** Refer 'How to Order' page