

# PC11

## SINGLE DISC NON-SLAM CHECK VALVES



### DESCRIPTION:

Single Disc Non-Slam Check Valves for general purpose applications. These valves are lighter and more compact than conventional swing check valves. The self-centering design facilitates easy installation between a wide variety of flange types.

### FEATURES:

- Can be mounted in any plane/direction
- Operate under extremely low opening pressures

**SIZES:** NPS ½ ~ 4

**PRESSURE RATING:** #300

**SUITABILITY:** For flanges as per ANSI #150/300

### INSTALLATION:

Between two pipe flanges using standard gasket on either side.

### MATERIAL:

NO.	PART	MATERIAL	QTY. (Nos)
1.	BODY	ASTM A351 Gr. CF8M	01
2.	DISC	AISI 316	01
3.	SPRING	AISI 316	01
4.	SPRING HOLDER	AISI 316	01

### SEATING

Standard	:	Metal seated
Optional	:	EPDM/Nitrile/Silicon/Viton

### DIMENSIONS:

 Nominal in inches

SIZE	A	B	C	D	Wt.
½"	2.36	0.6	1.5	0.67	0.33 lbs
¾"	2.76	0.79	1.85	0.79	0.44 lbs
1"	3.19	0.98	2.16	0.91	0.66 lbs
1¼"	3.54	1.26	2.68	1.1	1.27 lbs
1½"	3.98	1.57	2.99	1.26	1.54 lbs
2"	4.53	1.97	3.66	1.57	2.53 lbs
2½"	5.59	2.56	4.29	1.81	3.74 lbs
3"	6.06	3.15	5.04	1.97	4.84 lbs
4"	7.24	3.94	5.83	2.36	6.82 lbs

### ORDERING INFORMATION:

Refer 'How to Order' page

### CAUTION:

METAL SEATING NOT SUITABLE FOR  
HAZARDOUS/POISONOUS MEDIA

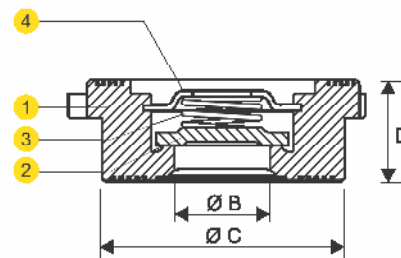
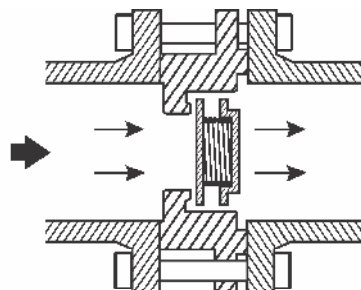
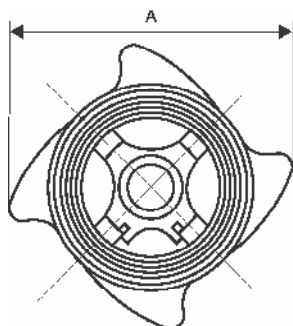

Local regulations may restrict the use of this product below the conditions quoted. Limiting conditions refer to standard connections only. In the interest of development and improvement of the product, we reserve the right to change the specifications without prior notice.