

PT67

HIGH CAPACITY FLOAT OPERATED STEAM TRAPS

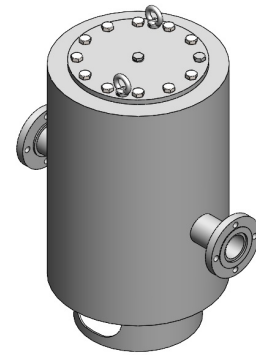

DESCRIPTION:

PT67 high capacity float operated traps with manual airventing facility. Designed for draining condensate from all types of low and medium pressure heating and process equipment. Typical applications include unit heaters, heat exchangers, driers and jacketed vessels.

FEATURES:

Modulating discharge.
Discharges condensate at steam temperature.

SIZES: DN80, 100, 150

CONNECTIONS: Flanged #150, #300

LIMITING CONDITIONS:

| | |
|---------------------------------|-----------|
| PMA: Max. allowable pressure | 15 bar(g) |
| TMA: Max. allowable temperature | 220 °C |
| PMO: Max.. operating pressure | 5 bar(g) |
| TMO: Max. operating temperature | 220 °C |

MATERIAL:

| NO. | PART | MATERIAL | QTY. (Nos) |
|-----|---------------------------------|-------------------------------------|------------|
| 1. | BODY SHELL | ASTM A106 Gr. B | 1 |
| 2. | COVER PLATE | ASTM A516 Gr. 70 | 1 |
| 3. | FLANGE | ASTM A105 | 2 |
| 4. | LEVER | AISI 304 | 1 |
| 5. | FLOAT ASSLY | AISI 304 | 1 |
| 6. | HOUSING ASSLY WITH SUCTION PIPE | AISI 304 | 1 |
| 7. | AIR VENT ASSLY. | AISI 304 | 1 |
| 8. | COVER GASKET | SPIRAL WOUND GRAPHITE WITH AISI 304 | 1 |
| 9. | DRAIN PLUG GASKET | COPPER | 2 |
| 10. | DRAIN PLUG | ASTM A743 Gr. CA40 | 1 |
| 11. | BOLT | ASTM A193 Gr.B7 | 12 |
| 12. | STAND | M.S. | 1 |
| 13. | EYE BOLT | AISI 304 | 2 |
| 14. | LABEL | AISI 304 | 1 |

INSTALLATION:

Horizontal installation.
The trap should be installed horizontally below the drain point of the equipment.

Max. differential pressure range:

PT67-2 : 2 bar

PT67-3 : 3 bar

PT67-5 : 5 bar

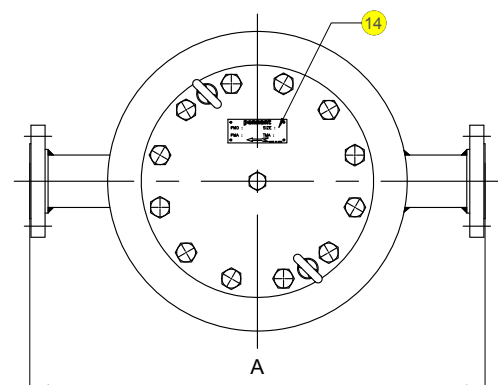
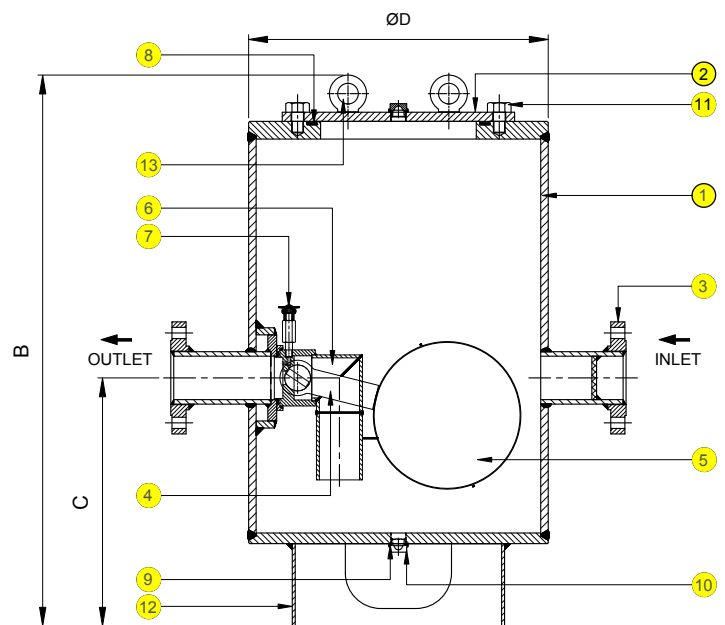

PT-67

High capacity float operated steam traps

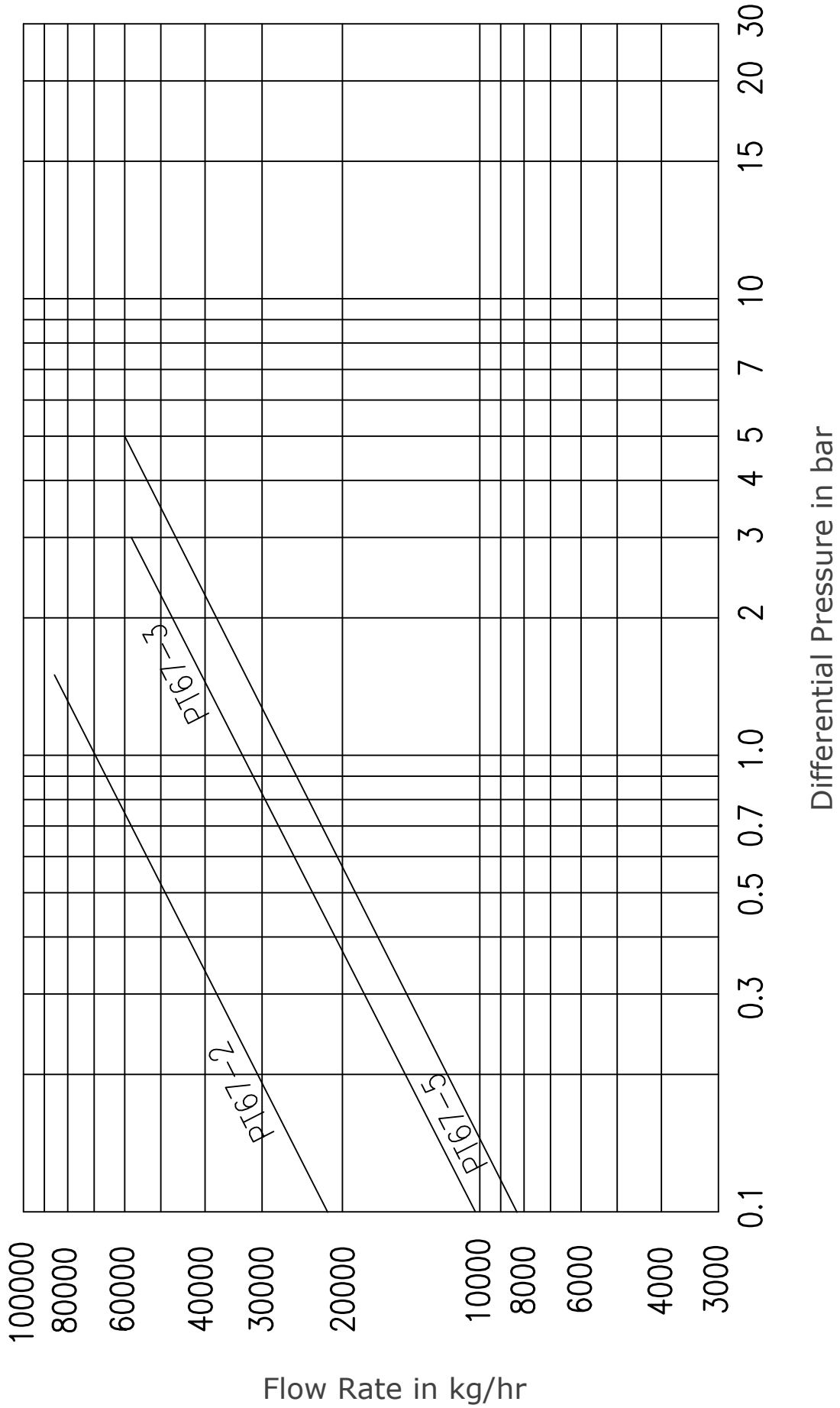

Local regulations may restrict the use of this product below the conditions quoted. Limiting conditions refer to standard connections only. In the interest of development and improvement of the product, we reserve the right to change the specifications without prior notice.