

PAE61

FLOAT TYPE AIR ELIMINATOR DN15, DN20



DESCRIPTION:

PAE61 ball float air eliminator is designed to automatically discharge air/gas present in liquid systems without loss of liquid.

SIZES: DN15, 20

CONNECTIONS: Screwed (NPT / BSPT / BSP)

LIMITING CONDITIONS:

| | |
|---------------------------------|-------------|
| PMA: Max. allowable pressure | 16 bar(g) |
| TMA: Max. allowable temperature | 220 °C |
| PMO: Max. operating pressure | 10.5 bar(g) |
| Cold hydro test pressure | 24 bar(g) |

AIR DISCHARGE CAPACITY AT 15 °C

| Diff. Pressure (bar) | Orifice size | m ³ /hr |
|----------------------|--------------|--------------------|
| 1.00 | 2.5 mm | 4.09 |
| 2.00 | | 6.14 |
| 3.00 | | 8.18 |
| 5.00 | | 12.28 |
| 7.00 | | 16.37 |
| 9.00 | | 20.46 |
| 10.50 | | 23.64 |

INSTALLATION:

Vertical installation with flow from bottom to top. The air eliminator should be installed at all high points of a liquid system wherever air can collect. It should be installed vertically above the pipe or equipment with inlet at the bottom. The arrow on the nameplate should be pointing vertically upwards.

AVAILABLE SPARES:

Valve Seat, Ball Float & Lever Assly., Gaskets

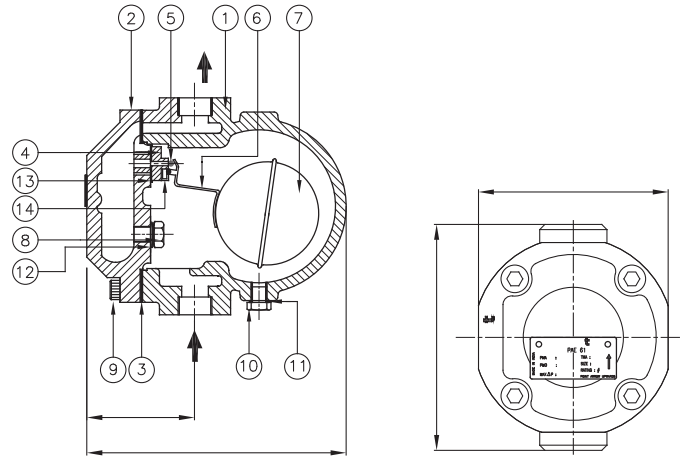

MATERIAL:

| No. | PART | MATERIAL | QTY. (Nos.) |
|-----|-------------------|-------------------|-------------|
| 1. | BODY | CAST IRON | 1 |
| 2. | COVER | IS : 210 FG200 | 1 |
| 3. | GASKET (COVER) | NON CAF | 1 |
| 4. | VALVE SEAT | AISI 410 / | 1 |
| 5. | VALVE | AISI 420 | 1 |
| 6. | LEVER | AISI 304 | 1 |
| 7. | FLOAT | AISI 304 | 1 |
| 8. | PLUG | AISI 304 | 1 |
| 9. | BOLT | HIGH TENSILE | 4 |
| 10. | DRAIN PLUG | C.S | 1 |
| 11. | GASKET DRAIN PLUG | COPPER | 1 |
| 12. | GASKET PLUG | COPPER | 1 |
| 13. | GASKET VALVE SEAT | COPPER | 1 |
| 14. | BRACKET ASSLY. | AISI 304 | 1 |

WEIGHT: (approx): 3.3 kg.

CAUTION:

DO NOT USE FOR HAZARDOUS/POISONOUS MEDIA